

Password Cabinet Lock User Manual

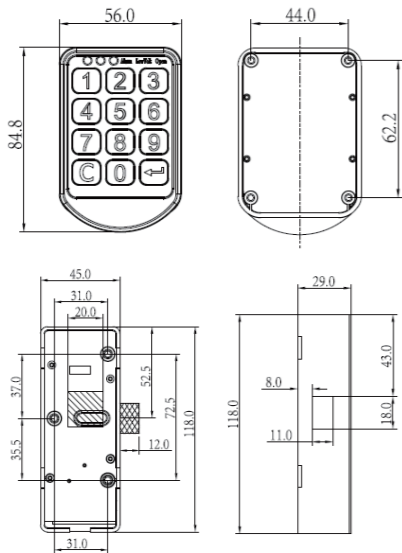

1.Product Size



1

2.Parts

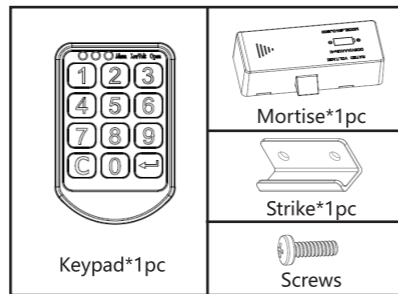

3.Installation Steps

- 3.1 Drill hole on cabinet door.
- 3.2 Fix Keypad on door front side.
- 3.3 Fix mortise on door back side.
- 3.4 Fix Strike based on mortise position.
- 3.5 Install batteries (4pcs AAA batteries)
- 3.6 Test the functions

4.Operation Introducing

Note: for confirm; for cancel

2

4.1 Factory default password

The default master password when first operation is "00000000".
The default user code when first operation is "1111".

4.2 Operation

- a) Input correct password(4~10 digits are available);
- b) Password correct, green LED lighting, latch moving in; Password incorrect, yellow LED flashing, latch not move
- c) Open the door

4.3 Mode Setting

There are 2 modes of these password cabinet lock: private mode and public mode.

Private mode:

Password: Password is private and fixed.
Operation: Close the door; Input correct user password to open the door.

Public mode:

Password: Password is set by casual user before every time to close the door. When lock at opening status, push the door to close, and input a password you want, press to confirm, door lock.

3

After door opened by this password, it invalid, lock will standby and waiting for next user to use.

Private Mode change to Public Mode:

- Step 1: Press Step 2: Press
- Step 3: Press "4" Step 4: Press
- Step 5: Input Master Password
- Step 6: Press

Public Mode change to Private Mode:

- Step 1: Press Step 2: Press
- Step 3: Press "5" Step 4: Press
- Step 5: Input Master Password
- Step 6: Press

4.4 Password Setting

a, Change User Password(For Private Mode)

Note: User code can be saved even power fail, and 4~10 digits password available.

- Step 1: Press 2 times;
- Step 2: Input old password;
- Step 3: Press ;

4

Step 4: Input new password;

Step 5: Press ;

Step 6: New password saved and effective; Green LED lighting, buzzer make 2 "beeps" means password changed successfully.

b, Change Master Password(For Private Mode and Public Mode)

Note: 6~10 digits numbers are available, can be saved even power fail. To make sure safety, it should be changed by admin of locks.

- Step 1: Press for 5 seconds; Yellow LED flashing;
- Step 2: Input old master password;
- Step 3: Press ;
- Step 4: Input new master password;
- Step 5: Press ; Green LED light, buzzer make 2 "beep" sound means change successfully;

5.Password Protection Function

Input wrong password, yellow LED flash 4 times, and buzzer make "beep" for 4 times; If input wrong password continuously 3 times, system will lock for 1 minute, and not work by any operation.

5

6.Low Power Alarm

When batteries power is low, input code to open lock, red LED will flash and with 4 groups alarm; When alarm for low voltage, lock still can be opened for 200 times.

7.Emergency

- 7.1 If user password forget, please use master password to open lock, user password will become to default "1111" after lock opened.
- 7.2 When batteries power low, please open lock with a battery box.

6